



Model: WMCH01  
Magnetic Wireless Car Charger  
for iPhone 15 / 14 / 13 / 12



User Manual ver 1.4

Designed for

- iPhone 15 / 14 / 13 / 12 Series

## Features

- Super strong magnets keep your iPhone securely in place even on bumpy road surfaces
- Perfect alignment ensures optimum fast wireless charging every time
- Works with MagSafe cases
- Supports 7.5W Apple wireless fast charging\*
- Full safety protection with temperature control, voltage regulation and short circuit protection
- Includes 1.2m USB-A to USB-C cable (does not include USB car charger)

**Note:** Does not work with non-MagSafe cases

## Specifications

- Wireless Standard: WPC/Qi (v1.2.4)
- Input: DC 5V/2A 9V/2A 12V/2A
- Wireless Output: 15W / 10W / 7.5W / 5W
- Charging Distance: 3 to 8mm
- Size: 92 x 61 x 7.5mm
- Weight: 68g
- Certifications: RCM, RoHS

\* When used with a QC2.0, QC3.0 or USB-C PD wall charger.

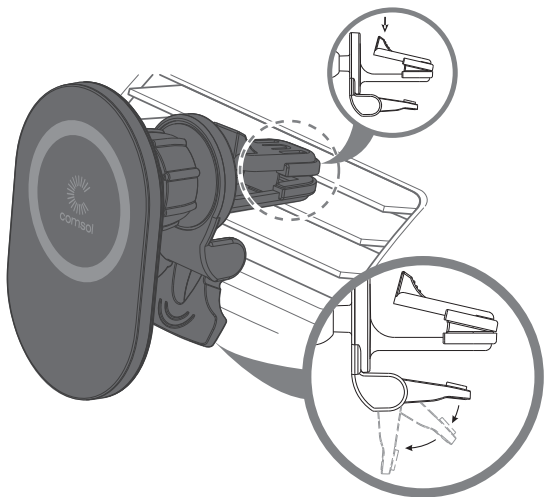

## Operating Instructions

- Connect the magnetic charger to the air vent by squeezing the clamp together and then release to secure to the vent
- Adjust the movable bottom piece to hold the charger securely in place as shown in the diagram above
- Connect the included USB-A to USB-C cable from the charger to your car's charging port or a USB-A car charger
- Place your iPhone onto the charger and the magnets will perfectly align for optimum wireless charging
- Once power is supplied to the charger from your vehicle, your phone should automatically start charging
- To remove your phone, simply pull your phone down and away from the charger

## Important Safety Instructions

- Only use original or reputable third party chargers
- Only use the product for the specified purpose of use
- Do not get wet to avoid causing short circuit damage and leakage
- Do not use in extreme hot, humid or corrosive environments to avoid short circuit damage and leakage
- Do not place too close to magnetic strip or chip ID card to avoid magnetic failure
- Do not place within 20cm of implantable medical devices (pacemaker, cochlear implant etc.) to avoid potential interference
- Do not clean with harmful chemicals or detergents
- Misuse, dropping or excessive force may cause damage to the charging dock
- Do not use the product if it is damaged or emits a suspicious odour
- Unplug the product from power sources when not in use

Please Note: When wirelessly charging a device, the wireless charger and your device may feel warm. This is a normal operating condition and should not be cause for concern.

iPhone is a trademark of Apple inc.,  
registered in the U.S. and other countries.

[www.comsol.com.au](http://www.comsol.com.au)



Made in China